



Overseas Certification



Features:

Two Mounting Methods.
Removable floor stand and wall mount



≥6000 cycles
at 90% DOD



1C/1C continual
charge and discharge



10 years
standard warranty



Superior LiFePO4
safety performance



Low voltage
safety connection



Max. 16 modules parallel

Compatible With Inverter Brands

GenixGreen's battery BMS supports simultaneous communication and compatible with multiple inverter brands



51.2V Wall Mounted LiFePO4 Battery

5.12kWh/7.68kWh/10.24kWh/14.34kWh/16.08kWh

GENIXGREEN®

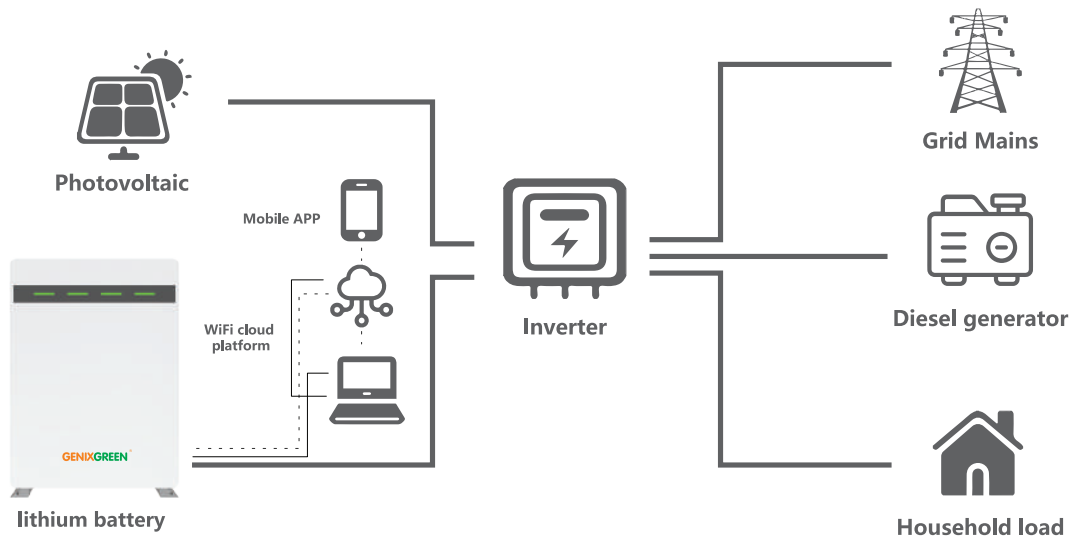

Parameters

Product Model	ES-BOX12	ES-BOX12 PRO	ES-BOX12 PLUS	ES-BOX12 MAX	ES-BOX12 MAX+
Nominal Energy	5.12kWh	7.68kWh	10.24kWh	14.34kWh	16.08kWh
Nominal Voltage	51.2V	51.2V	51.2V	51.2V	51.2V
Nominal Capacity	100Ah	150Ah	200Ah	280Ah	314Ah
Cell Type	LFP	LFP	LFP	LFP	LFP
Standard Charge Voltage	56.8V	56.8V	56.8V	56.8V	56.8V
Max. Discharge Current	100A	150A	150A	200A	200A
Discharge Cut-off Voltage	44.8V	44.8V	44.8V	44.8V	44.8V
Parallel Function	Support 16 Units In Parallels				
Communication Interface	RS485、USB/RS232、CAN				
Cycle Life *	≥6000 Cycles (25°C±2°C, 0.2C/0.2C, 90%DOD)				
Charge Temperature Range	0~55°C				
Discharge Temperature Range	-20~55°C				
Certification	Pack: CEI 0-21/CE/IEC 62619/UL1973 by Intertek/MSDS/UN38.3 Cell: UL 1642/IEC 62619/CE/EMC/ROHS/MSDS/UN38.3				
Dimension	480*600*150mm	480*650*180mm	480*650*225mm	490*840*242mm	490*840*242mm
Net Weight	52Kg	69Kg	89Kg	123Kg	127Kg
Installation Method	Wall Mounted/Floor Standing				
Warranty	10 Years(underwarrantyterms				
Optional	WIFI remote Monitoring				

*Test Condition: 90% DOD, 0.2C charge & discharge @25°C